



Merseytravel

Formby Interchange

Interchange Information

Formby Circulars

Monday to Saturday off-peak (0900-1600)

| Minutes past each hour | Travelling to | Via | Route Number | Departure Stop |
|------------------------|----------------|----------------|--------------|----------------|
| 09 | Balmoral Drive | Shorrocks Hill | 163 | C |
| 10 | The Royal | Formby Village | 160 | A |
| 10 | Balmoral Drive | Shorrocks Hill | 163 | B |
| 24 | Formby Village | Duke Street | 163 | C |
| 25 | Squirrel Green | Harington Road | 160 | B |
| 40 | The Royal | Formby Village | 161 | A |
| 55 | Formby Village | Harington Road | 161 | B |

Monday to Saturday peak (0700-0900 and 1600-1924)

| Minutes past each hour | Travelling to | Via | Route Number | Departure Stop |
|------------------------|----------------|----------------|--------------|----------------|
| 09 | Balmoral Drive | Shorrocks Hill | 163 | C |
| 09 (until 1809) | Formby Village | The Royal | 164 | A |
| 10 | Balmoral Drive | Shorrocks Hill | 163 | B |
| 23 (until 1823) | Formby Village | Harington Road | 164 | C |
| 24 | Formby Village | Duke Street | 163 | C |
| 25 | Formby Village | Harington Road | 164 | B |
| 39 | Formby Village | The Royal | 164 | A |
| 53 | Formby Village | Harington Road | 164 | C |
| 55 | Formby Village | Harington Road | 164 | B |

Sundays

| Minutes past each hour | Travelling to | Via | Route Number | Departure Stop |
|------------------------|----------------|----------------|--------------|----------------|
| 13 (1013 - 1713) | Formby Village | Duke Street | 165 | A |
| 26 (1026 - 1726) | The Grapes | Squirrel Green | 165 | B |

Formby Interchange Map

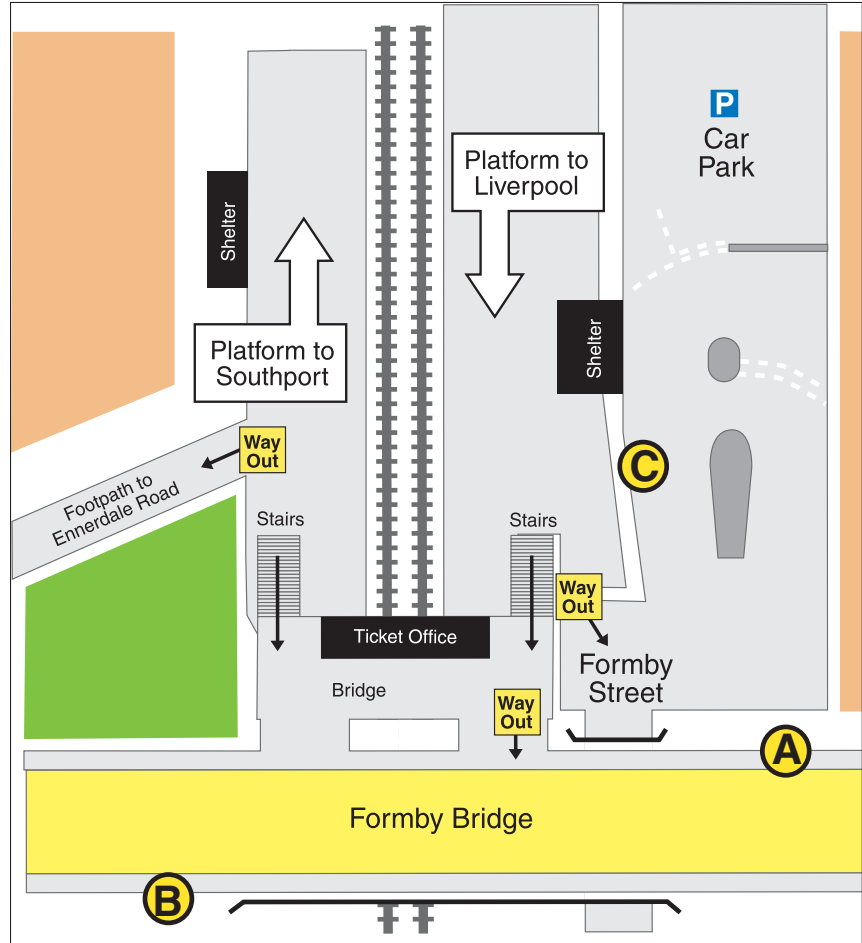

| Mondays to Saturdays | 164 | 164 | 164 | 164 | 160 | 161 | 160 | 161 | 160 | 161 | 164 | 164 | 164 | 164 | 164 | 164 |
|---|-------------|-------------|-------------|-------------|-------------|-------------|------------|-----|------------|------|-------------|-------------|-------------|-------------|-------------|-------------|
| Formby Station stop A | 0709 | 0739 | 0809 | 0839 | 0910 | 0940 | 10 | 40 | 1510 | 1540 | 1609 | 1639 | 1709 | 1739 | 1809 | 1839 |
| Formby Village Chapel Lane | - | - | - | - | 0913 | 0943 | 13 | 43 | 1513 | 1543 | - | - | - | - | - | - |
| Alt Road, Romsey Avenue | 0716 | 0746 | 0816 | 0846 | 0919 | 0949 | then at 19 | 49 | 1519 | 1549 | 1616 | 1646 | 1716 | 1746 | 1816 | 1846 |
| Formby Village Sumner Road | 0719 | 0749 | 0819 | 0849 | 0922 | 0952 | these 22 | 52 | 1522 | 1552 | 1619 | 1649 | 1719 | 1749 | 1819 | 1849 |
| Formby Station Bus Turnaround stop C | 0723 | 0753 | 0823 | 0853 | - | - | minutes - | - | - | - | 1623 | 1653 | 1723 | 1753 | 1823 | 1853 |
| Formby Station stop B | 0725 | 0755 | 0825 | 0855 | 0925 | 0955 | past 25 | 55 | until 1525 | 1555 | 1625 | 1655 | 1725 | 1755 | 1825 | 1855 |
| Woodlands Primary School | 0727 | 0757 | 0827 | 0857 | 0927 | 0957 | each 27 | 57 | 1527 | 1557 | 1627 | 1657 | 1727 | 1757 | 1827 | 1857 |
| Squirrel Green (for Nature Reserve) | 0729 | 0759 | 0829 | 0859 | 0929 | 0959 | hour 29 | 59 | 1529 | 1559 | 1629 | 1659 | 1729 | 1759 | 1829 | 1859 |
| Freshfield Station stop B | 0730 | 0800 | 0830 | 0900 | 0930 | 1000 | 30 | 00 | 1530 | 1600 | 1630 | 1700 | 1730 | 1800 | 1830 | 1900 |
| Formby Village Sumner Road | 0733 | 0803 | 0833 | 0903 | 0933 | 1003 | 33 | 03 | 1533 | 1603 | 1633 | 1703 | 1733 | 1803 | 1833 | 1903 |

| Mondays to Saturdays | 163 | 163 | 163 |
|---|-------------|------------|-------------|
| Formby Station Bus Turnaround stop C | 0709 | then at 09 | 1909 |
| Formby Station stop B | 0710 | these 10 | 1910 |
| Shorrocks Hill, Bushby's Lane | 0712 | minutes 12 | 1912 |
| Park Road, Windsor Road | 0718 | past 18 | until 1918 |
| Formby Station Bus Turnaround stop C | 0724 | each 24 | 1924 |
| Formby Village Sumner Road | 0727 | hour 27 | 1927 |

| Sundays | 165 | 165 | 165 |
|-----------------------------------|-------------|------------|------------|
| Formby Station stop A | 1013 | 13 | 1713 |
| Formby Village Sumner Road | 1016 | then at 16 | 1716 |
| Alt Road, Romsey Avenue | 1020 | these 20 | 1720 |
| Formby Village Sumner Road | 1023 | minutes 23 | 1723 |
| Formby Station stop B | 1026 | past 26 | until 1726 |
| Freshfield Station stop D | 1031 | each 31 | 1731 |
| Deansgate Lane, Southport Road | 1035 | hour 35 | 1735 |
| Formby Village Sumner Road | 1039 | 39 | 1739 |

Other buses from Stop A

Rail replacement services towards Hunts Cross and Southport operate from this stop.

Other buses from Stop B

44 To: **CROSSENS** From 03/09/2012
Via: Church Road, Liverpool Road, Mill Road, Heathfield Road, Bentham's Way, Town Lane, Southport Hospital, Haig Avenue, Virginia Street, Lord Street, Queens Road, Cambridge Road, Marshside Road, Fylde Road

| MONDAY TO FRIDAY | SATURDAY | SUNDAY |
|---|--|--|
| 6.33am 7.03am 7.33am 8.00am 8.30am 9.03am 9.33am THEN EVERY 30 MINUTES AT 03 33 MINUTES PAST EACH HOUR UNTIL 6.03pm 6.18pm* 6.50pm* 7.50pm* 8.50pm* 9.50pm* 10.50pm* | 6.33am THEN EVERY 30 MINUTES AT 03 33 MINUTES PAST EACH HOUR UNTIL 6.03pm 6.50pm* 7.50pm* 8.50pm* 9.50pm* 10.50pm* | 9.50am* THEN EVERY HOUR AT 50* MINUTES PAST EACH HOUR UNTIL 10.50pm* |

CODES: □ Journey operates to Raven Meols Lane, Liverpool Road only
● Journey operates via Ward Avenue

Further information and help

traveline 0871 200 22 33
public transport info
Calls may be recorded.

Open from 8am until 8pm
7 days a week
Visit our website for details of pricing

Timetables for these bus services are available from the station booking office.

www.merseytravel.gov.uk



Download maps and timetables



TravelWise is a campaign to help people on Merseyside make sustainable transport choices - public transport, walking, cycling and using cars wisely.

This display has been produced by Merseytravel. We've done our best to make sure the information is correct, but we're not legally responsible for any mistakes. The information might change, especially during public holidays.